

Lift Title: BIG CAL Absorber Plate Removal/Install

Lift #: C-08-006-L

Date 02/29/08

Complete all information. Use as many sheets as necessary.	
Lift location: Hall C	Prepared by: A. Kenyon
Division: PHY	Reviewed by (worker): <i>[Signature]</i>
Department: Hall C	Reviewed by (worker): <i>[Signature]</i>
Supervisor: W. Kellner	Approved by: <i>[Signature]</i>
Standard Requirements: Hardhats, safety shoes, gloves. Journeyman rigger and crane operator. Follow standard rigging procedures and EH&S 6140 Crane & Hoist, 6147 Aerial Work Platforms, 6132 Ladders and Scaffolds, and 6131 Trip and Fall Protection	

Step	Description	Safety Procedures/Practices/ Controls
1.	What is to be lifted?	Big Cal absorber plates
2.	Are there any special precautions?	na
3.	What is the weight of the load?	500 lbs
4.	Where is the center of gravity?	Centered on plate
5.	Is the load stable? Does it need to be stabilized?	Yes ;
6.	What is the capacity of the crane/hoist?	20T
7.	Classify the lift per Appendix 6140-T4 of EH&S manual.	Not a special lift
8.	List each piece of equipment, accessory, and rigging component, by type and rated capacity, that will be used during the lift.	
	Crane	20t crane
	Hoist	na
	Fork Truck	na
	Slings (identify the configuration used: choker, basket, or vertical, and angle (see Figure 1 below))	2 6' 1000 lb cap min
	Shackles	2 1 ton cap min
	Eye Bolts/Swivel Eyes	2 1/2 swivel 5000 lbs WLL
	Other (Special Lifting Fixture, Below the Hook Lifting Devices, Multi Leg Bridle, etc)	na
9.	What rigger calcification is required? Journeyman/Master	Journeyman
10.	What personnel will you need to assist with the lift?	

Lift Title: BIG CAL Absorber Plate Removal/Install

Lift #: C-08-006-L

Date 02/29/08

Step	Description	Safety Procedures/Practices/ Controls
	Crane operator	Lumanog/Lassiter
	Fork operator	na
	Rigger	Lumanog/Nines
	Spotter	Carraway
	Other	na
11.	Safety Equipment	Hard hat as needed, fall protection
12.	Has rigging been inspected?	
12.a	Additional information	

Lift Title: BIG CAL Absorber Plate Removal/Install

Lift #: C-08-006-L

Date 02/29/08

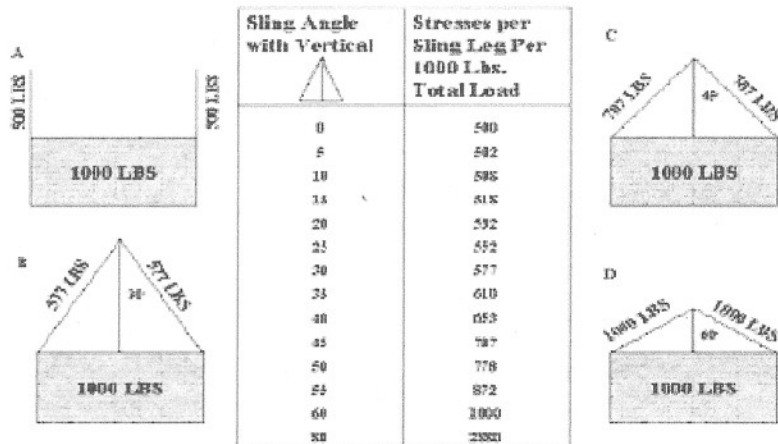

Figure 1: Sling Load

The chart may be used as a guide for assessing sling load.

On the rigging sketch (Figure 2) identify the following:

1. Lift points
2. Shackles/swivel eyes
3. Slings, sling angles, and sling loads
4. Accessories
5. Capacities

Lift Title: BIG CAL Absorber Plate Removal/Install

Lift #: C-08-006-L

Date 02/29/08

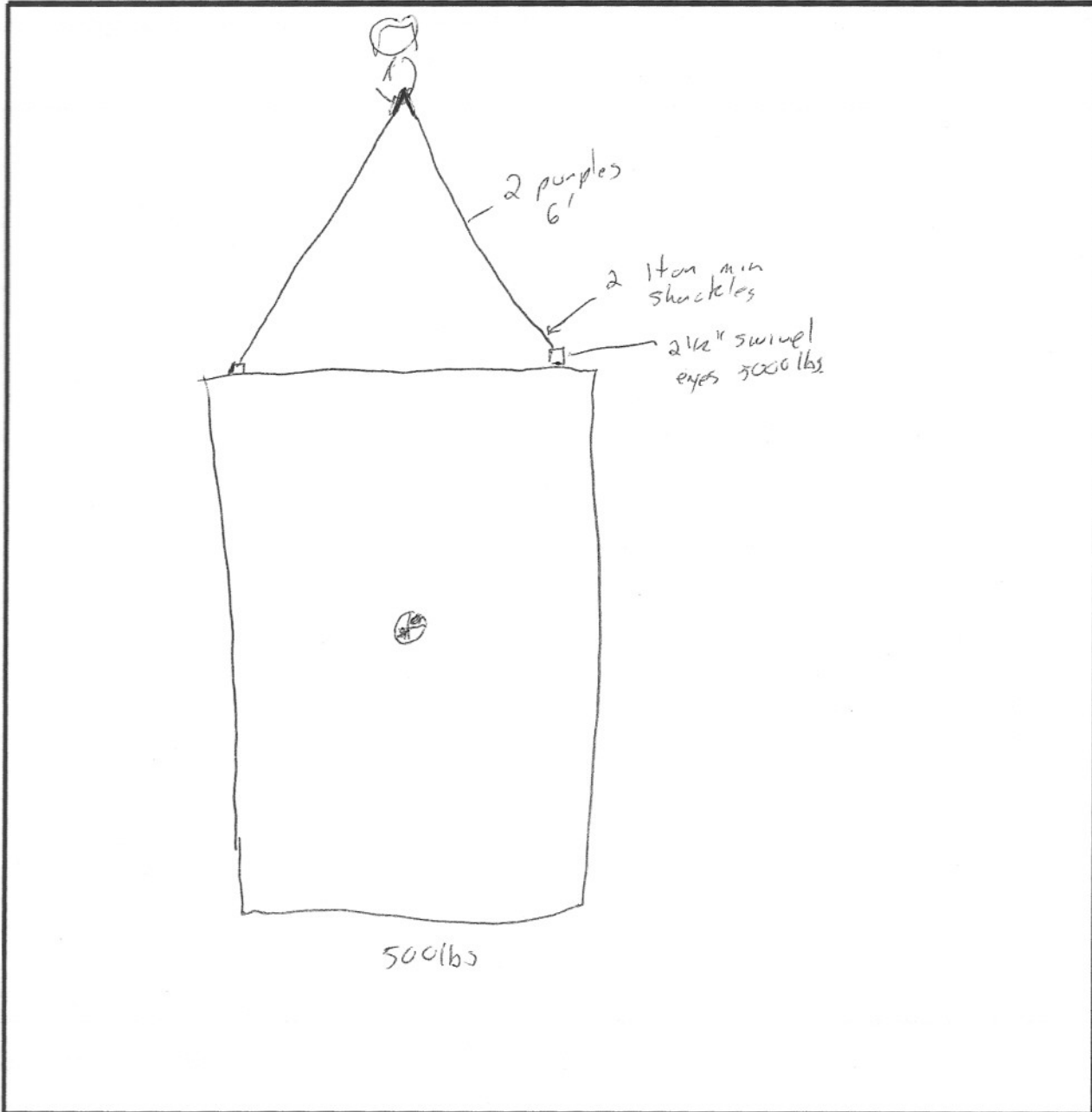

Figure 2: Rigging Sketch

Lift Title: BIG CAL Absorber Plate Removal/Install

Lift #: C-08-006-L

Date 02/29/08

Sketch the load path for limited access pick or complex (or higher) lifts. Include all relevant aspects such as load height, obstructions, crane speeds etc.

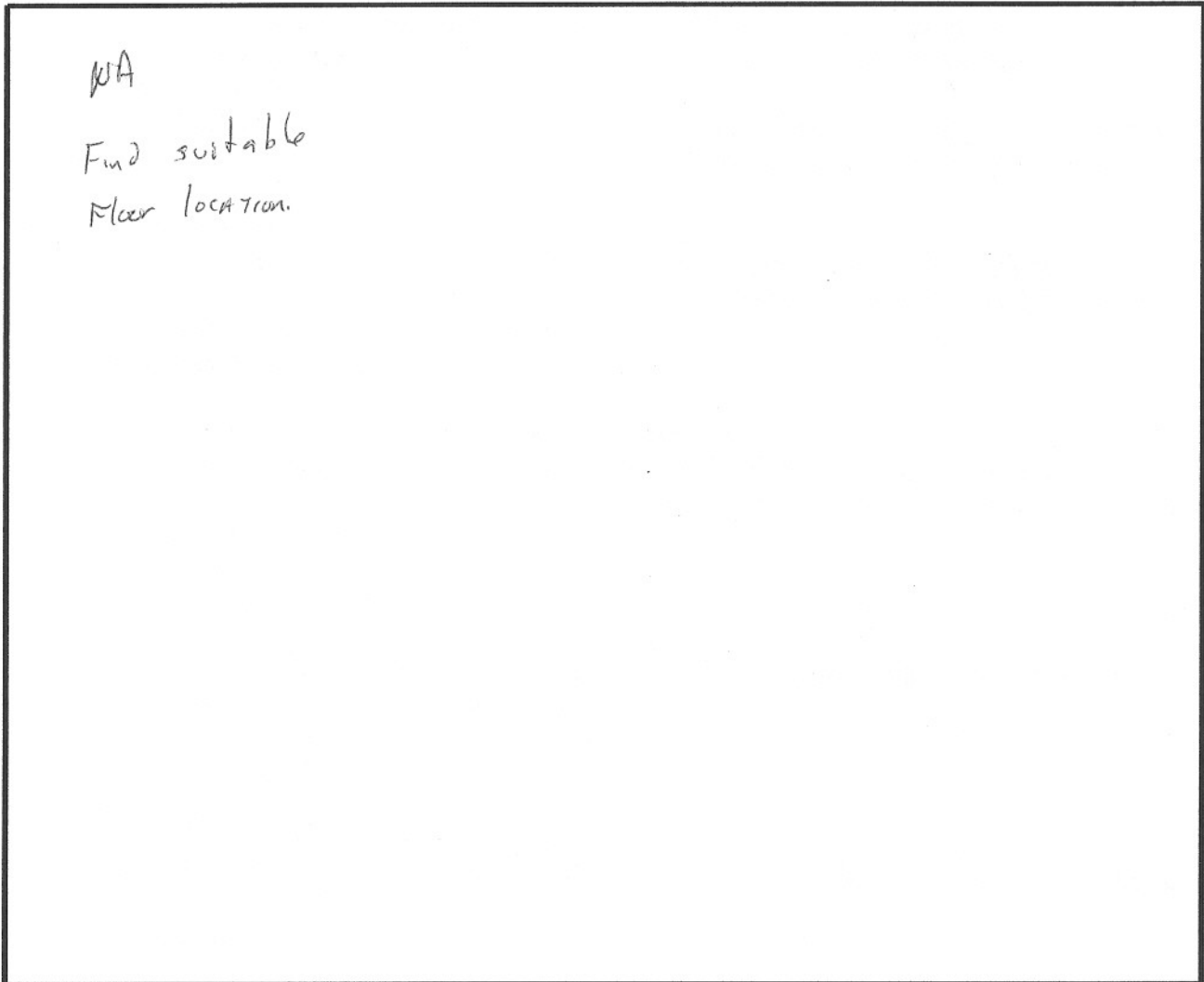

Figure 3: Load path Sketch

Lift Title: BIG CAL Absorber Plate Removal/Install

Lift #: C-08-006-L

Date 02/29/08

Lift Classification per Appendix 6140-T4 of EH&S manual.

I. Complex or unusual lift

A. Criteria(and/or)

1. Is outside the normal parameters expected of the group assigned the work
2. Is in a location with limited room to work and/or clearances for the equipment to operate

B. Actions(and)

1. Shall at the direction of the Group Leader assigned the task or the customer, require additional planning and documentation such as a Lift Plan or TOSP prior to starting work.

C. Interpretation/Demystification

1. Is lift not normally done and dissimilar to any other lift done. Is in a tight spot.
2. At the discretion of the boss, a lift plan task hazard analysis, and/or TOSP may be necessary but not required by default

II. Potentially high-risk lift

A. Criteria(and/or)

1. Exceeds 90% of an onsite crane's rated capacity
2. Due to its location poses an unacceptably high risk to personnel or equipment in the area of the operation as determined by the Group Leader, customer or supervisor of the team assigned the task.

B. Actions(and)

1. Shall require at a minimum: Approval by the MHSR and Group Leader of the lift plan and/or a TOSP.
2. The crane to be used shall at the discretion of the MHSR or MHER be inspected (48-hour notice is required if an inspection is required).

C. Interpretation/Demystification

1. Is rated a THA level 3 or 4.
2. MHSR=Material Handling Safety Representative
3. MHER=Material Handling Equipment Representative
4. TOSP is not required by default but may be done in lieu of or in addition to a lift plan.

III. Critical Lift

A. Criteria(and/or)

1. Any lift that meets the criteria of a Complex, Unusual or Potentially High Risk Lift and/or
2. Has two or more cranes working in unison or tandem to accomplish the lift.
3. Is deemed a Critical Lift by the Customer, Dept. Head or Group Leader.
4. Involves high value equipment, components or facilities.
5. Would greatly impact the work schedule if material was damaged or destroyed.

Lift Title: BIG CAL Absorber Plate Removal/Install

Lift #: C-08-006-L

Date 02/29/08

6. Due to risk to the environment.
 7. **NOTE:** At the discretion of the customer, Group Leader and/or Dept. Head a "Critical Lift" can be down graded to a lower classification if they believe that the Supervisor/SOTR's experience, knowledge and proven history does not require the level of documented planning laid down in this section. These involved parties may set their own graded requirements as long as it is documented, risk based, and the SOTR/Supervisor agrees.
- B. Actions(and)
1. All such Critical Lifts shall require an approved, documented plan in the form of a TOSP, OSP or SOP and a lift plan.
 2. All rigging equipment shall be inspected prior to use by the supervisor, PIC, and/or MHSR.
 3. The crane to be used shall at the discretion of the MHSR or MHER, be inspected prior to use. (48-hour notice if an inspection is required)
- C. Interpretation/Demystification
1. SOTR=Subcontracting Officer's Technical Representative
 2. PIC=Person In Charge
 3. A critical lift can be downgraded to a lower classification.