

NOTES:

1. Design based on CERN'S type 4244.
2. All resistors are SMT, size 1206 - 4W except as noted.
3. Resistors R14, R16, R17, R20 and R21 are SMT, size 0805.
4. All capacitors are SMT, X7R ceramic, 500 V, size 1206, except as noted.
5. Capacitor C7 is SMT ceramic, size 0805.
6. BNC connector has ground isolated from ground on SHV connector.

AMP-227161-7

Title			XP2262 PMT BASE		
Size	Number	Rev			
B	HALL C				
Date	20 Sep 2004	Drawn by	FJB		
Filename	XP2262.SCH	Sheet	1 of 1		

XP2262-V2 BILL OF MATERIALS					
QTY.	REFDES	PAK. TYPE	PART #	COMP. TYPE	DIGI-KEY*
3	D4, D5, D6	T-18	1N5378B	ZENER REG.	1N5378BMSCT-ND
4	D1, D2, D3, D7	T-18	1N5383B	ZENER REG.	1N5383BMSCT-ND
1	C6	1206	0.01uF	HV CAP, 630V	PCC2292CT-ND
3	C1, C2, C3	1206	1000pF	HV CAP, 630V	PCC2291CT-ND
1	C4	1206	2200pF	HV CAP, 630V	PCC2293CT-ND
1	C5	1206	4700pF	HV CAP, 630V	PCC2294CT-ND
1	C7	805	0.01uF	CAP	PCC103BNCT-ND
1	R21	805	10K	RES	P10.0KCCT-ND
3	R14, R16, R17	805		51 RES	P51.1KCCT-ND
1	R20	805		100 RES	P100KCCT-ND
7	R1, R2, R12, R13, R15, R18, R19	1206-1/4W-5%	1.5M	RES	P1.50MECT-ND
7	R3, R5, R6, R7, R8, R9, R10	1206-1/4W-5%	121K	RES	P121KECT-ND
1	R11	1206-1/4W-5%	150K	RES	P150KECT-ND
1	R4	1206-1/4W-5%	161K	RES	P162KECT-ND
1	J1	COAX	AMP 227161-7	COAX CONN.	A24489-ND
1		SHV	PE4239	SHV CONN.	PASTERNAK
1	90 degree header, 14 pin, separate before assembly				WM6114-ND

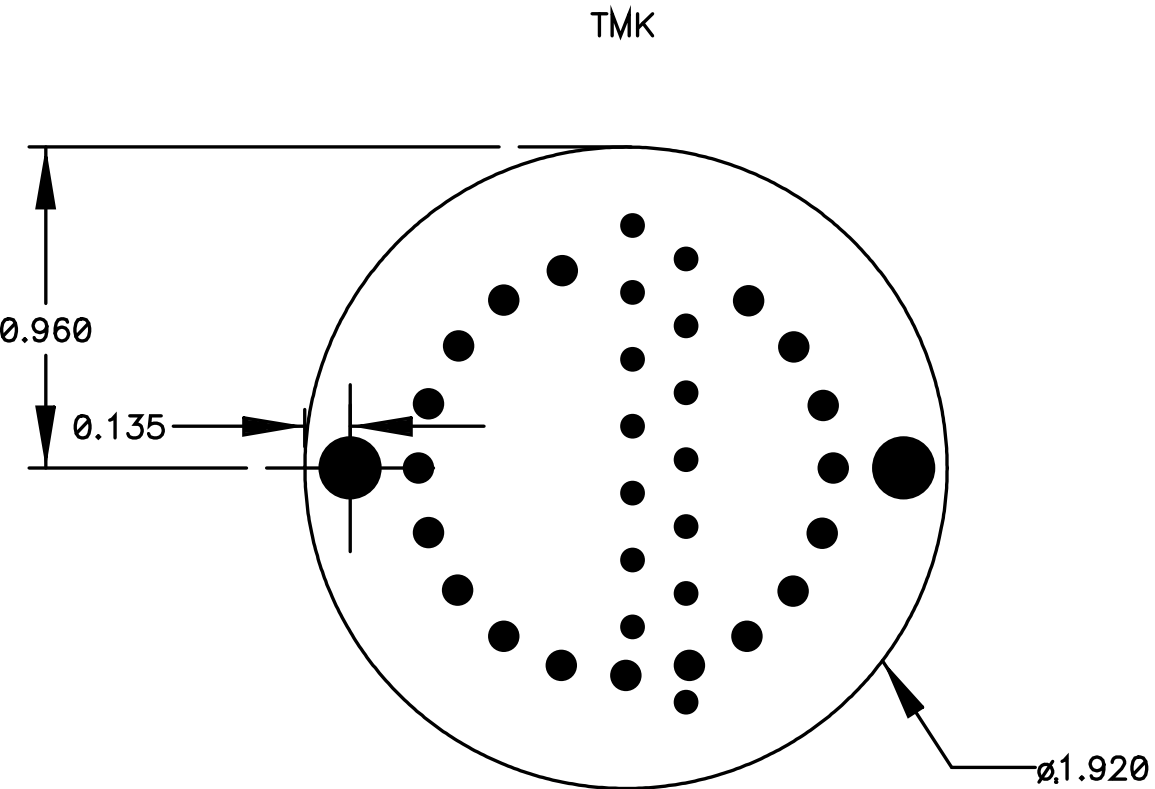

## XP2262-BASE SPECS:

1. 1.920" Diameter, 0.062" THICK, FR-4, 1 OZ. COPPER.
2. 2 LAYER, SMOBC LPI GREEN.
3. 0.010"/ 0.010" MIN. TRACE/ SPACE.
4. Permanent White Epoxy Silk-screen.
5. SMT PADS: NA
6. PTH DRILLS
 

SIZE	Number
0.038	14
0.045	18
0.125	2
7. Front-to-Back registration less than 0.005"
8. Warp and Twist 0.007" per inch or better.

9. Layer Stack-Up
 

Silk Screen Top	TSK
Solder Mask Top	TMK
Top	TOP
Bottom	BOT
Solder Mask Bot	BMK

TOP

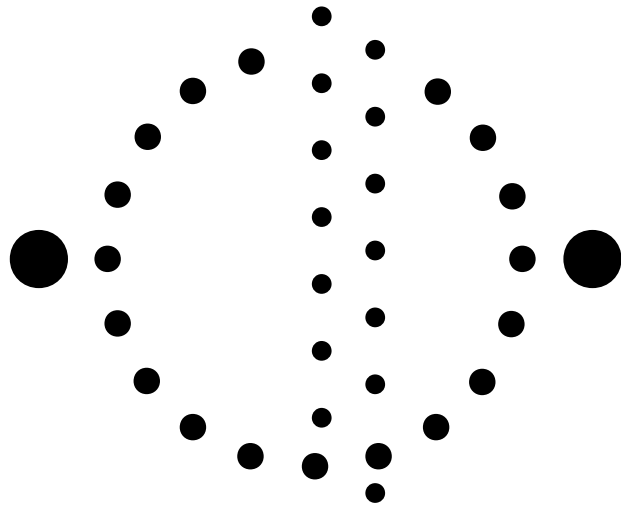

BMK

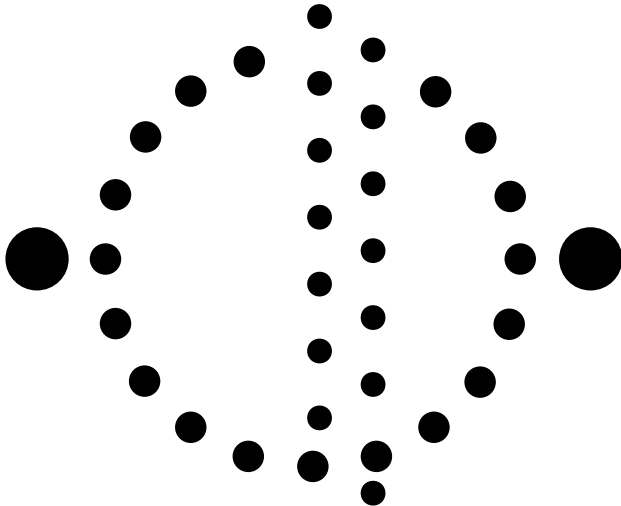

TMK

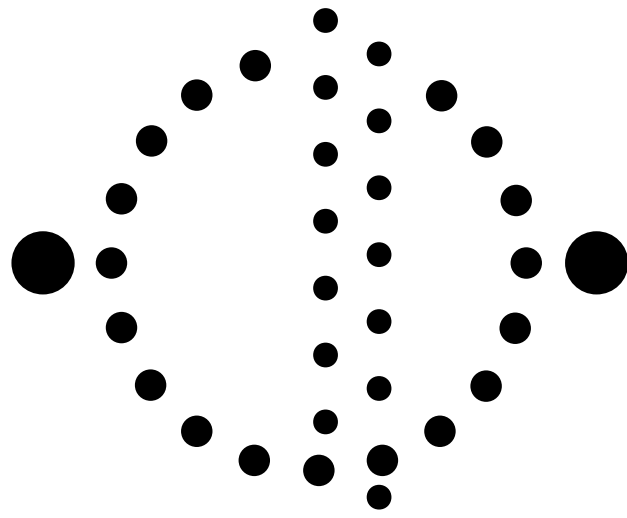

Top side

TOP

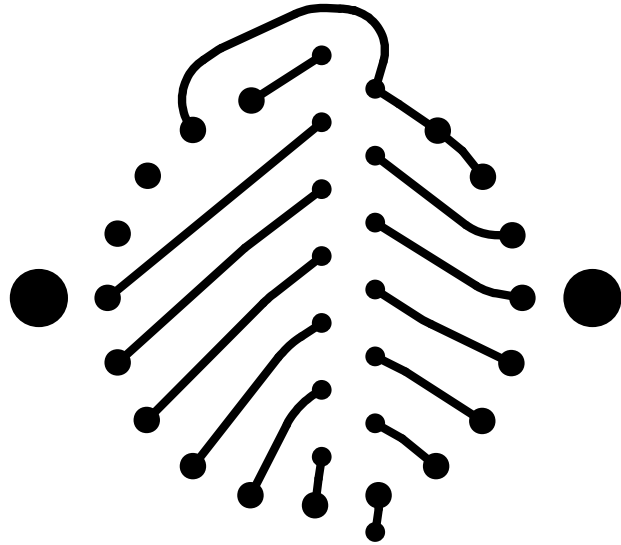

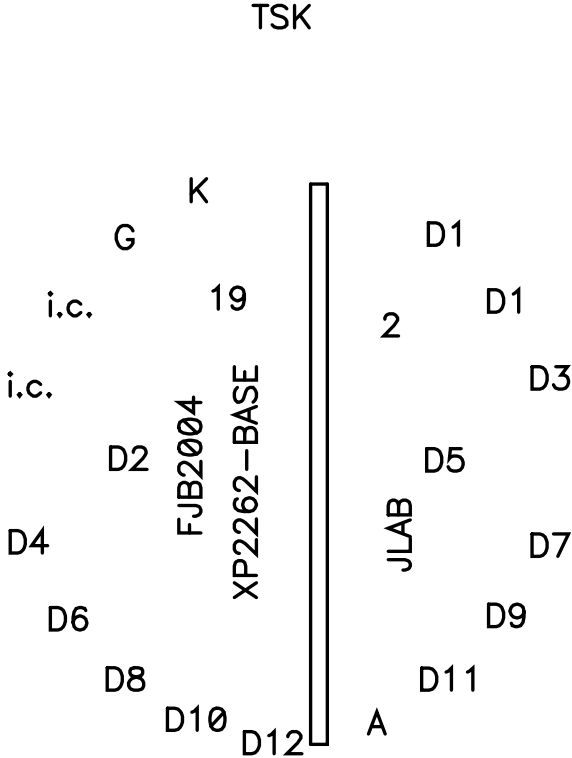



Drill locations

