

DETAIL OF A CONNECTION

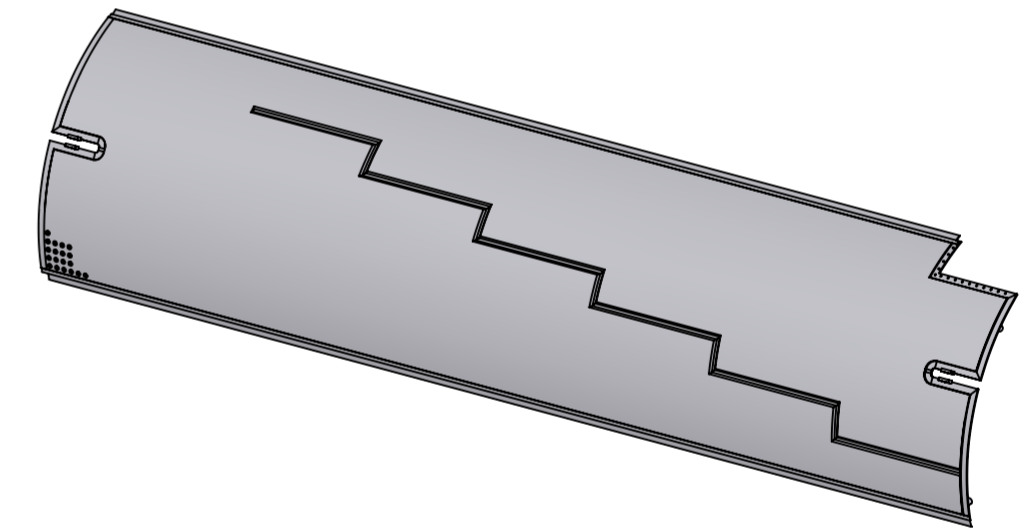

min width for flow: 50mm

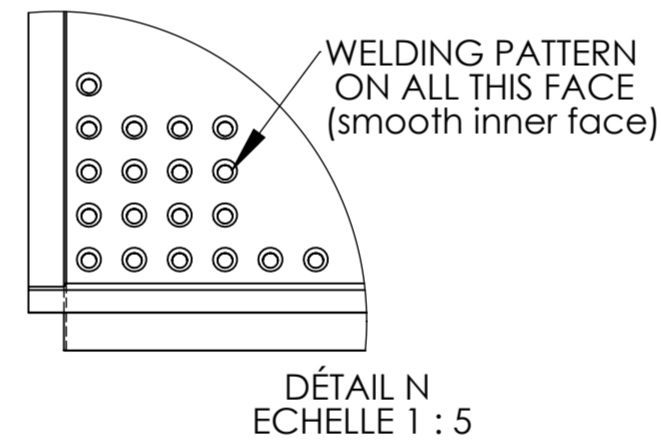
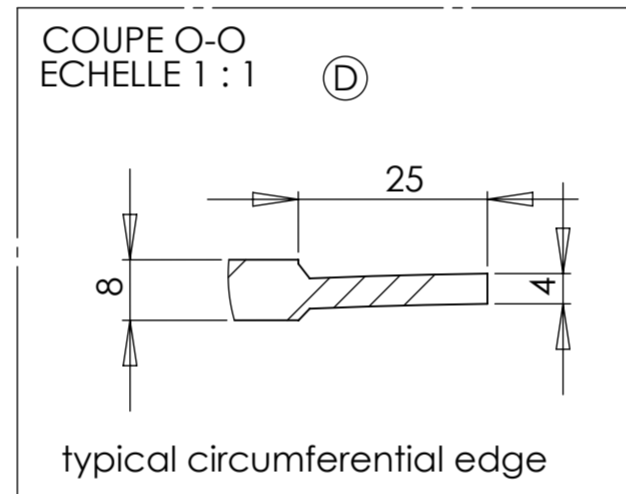
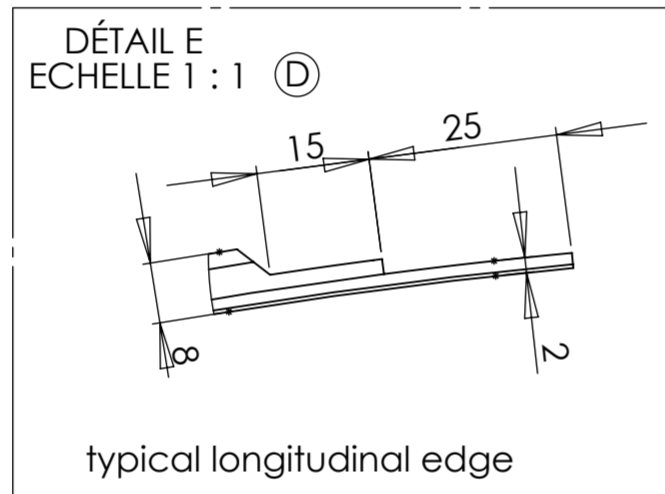
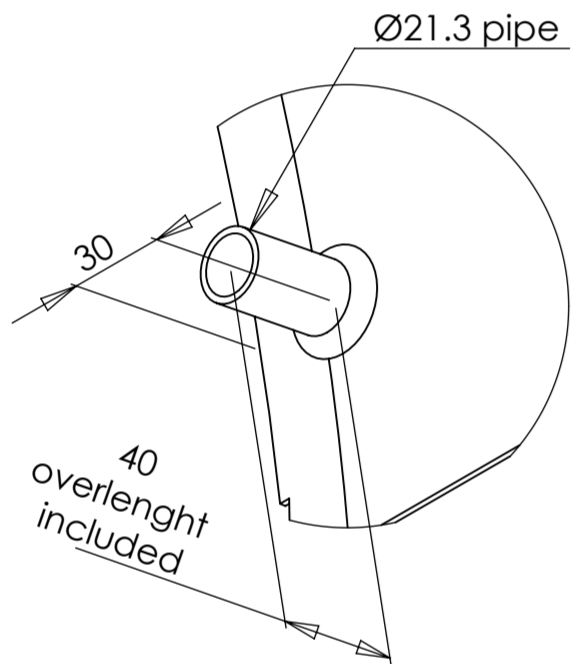
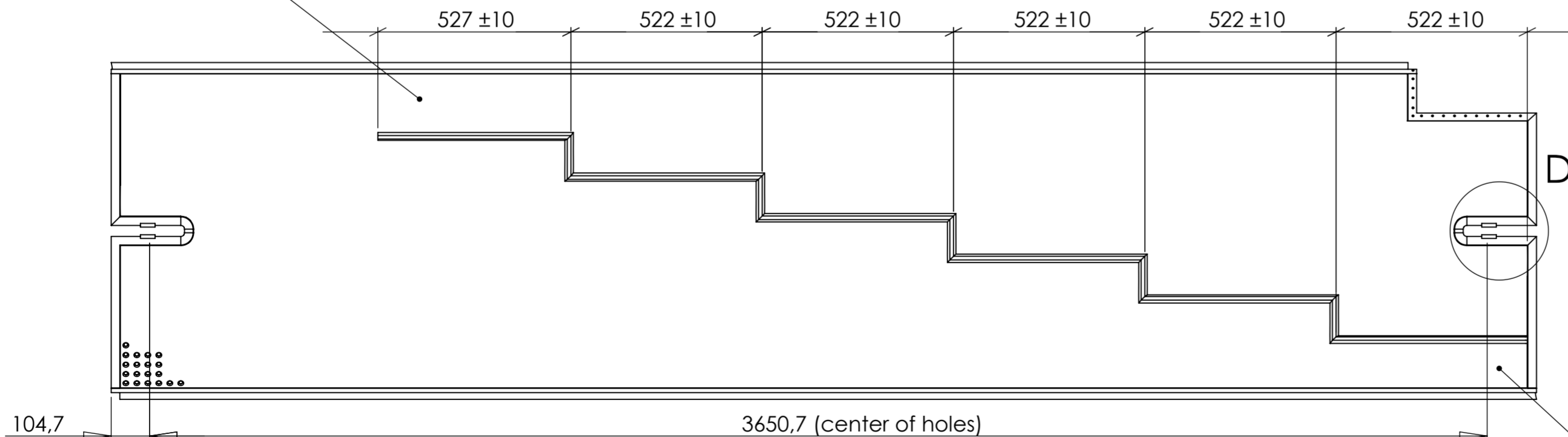

min width for flow: 50mm

**NOTE:**  
 - All dimensions in mm.  
 - Continuous weld along the edges and serpentine pattern.  
 - Content liquid nitrogen at 70°K.  
 - Design pressure: 6atm absolute from 60°K to 300°K.  
 - Design and manufacturing according to AMSE BPV.  
 - Final manufacturing drawings & control plan to be provided by the supplier and approved by SIGMAPHI.

REVISIONS				
ZONE	REV.	DESCRIPTION	DATE	APPROUVE
	D	changed edges design	04/07/2012	
	E	oblong hole 5=>7	29/11/2012	
	F	changed dimension between holes	14/03/2013	

 <b>SIGMAPHI</b> z du pval Rue des frères Mongollier F-56000 Vannes Tel:(33) 02.97.01.08.80 Fax (33)02.97.01.08.81 EMAIL Contact@sigmaphi.fr	Name	M. Delbecq	Date	16/04/2013	
	Drawing				
	Checked				
	Approved				
MATERIAL:	304L (X2CrNi18-9)				
Trait.:					
Roughness:					
Toi Gen	+/-3				
Supplier:					
Weight:	121.00 Kg				
	0.00				
File name:317111-JLA-702-002					
DWG NO.	<b>317111-JLA-702-002</b>			Rev:	<b>F</b>
This drawing may not be used without special licence or authorisation express (Law of the 11 march 1957)					