

DETAIL OF A LUG

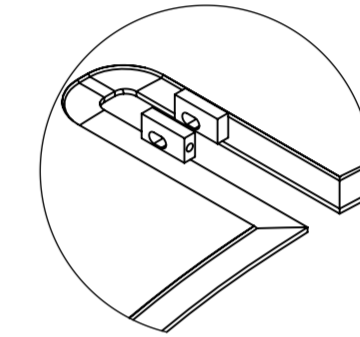

DETAIL OF A CONNECTION

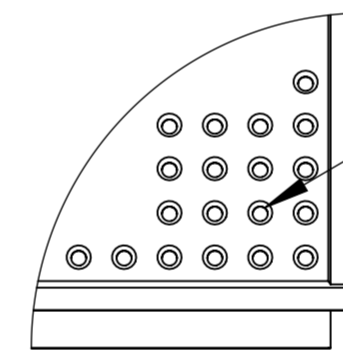
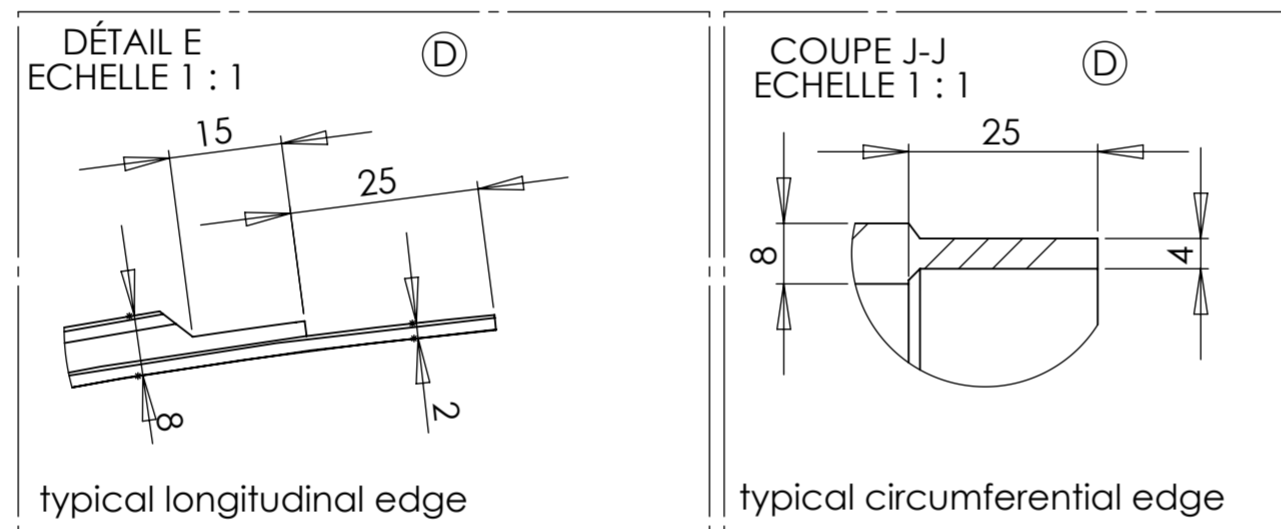
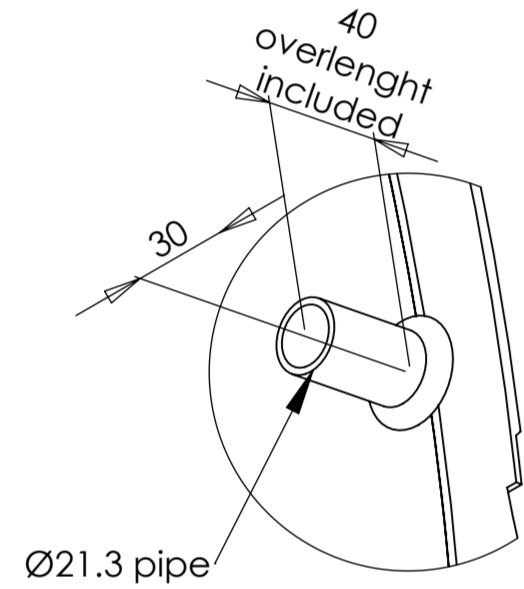

WELDING PATTERN ON ALL THIS FACE (smooth inner face)

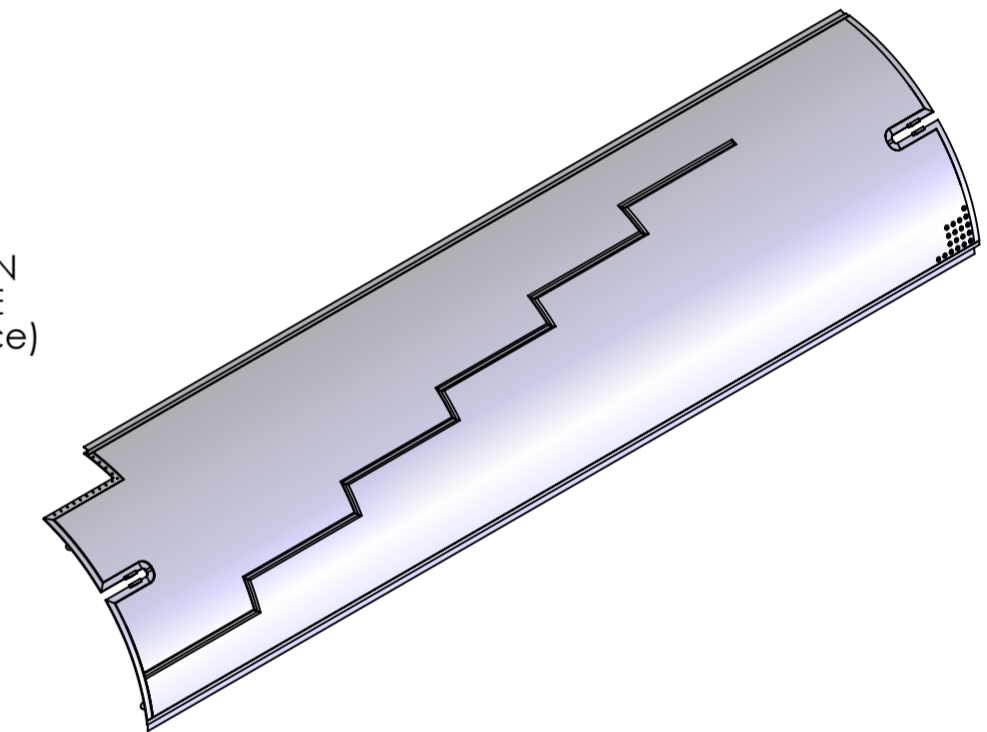

**NOTE:**  
 - All dimensions in mm.  
 - Continuous weld along the edges and serpentine pattern.  
 - Content liquid nitrogen at 70°K.  
 - Design pressure: 6atm absolute from 60°K to 300°K.  
 - Design and manufacturing according to AMSE BPV.  
 - Final manufacturing drawings & control plan to be provided by the supplier and approved by SIGMAPHI.

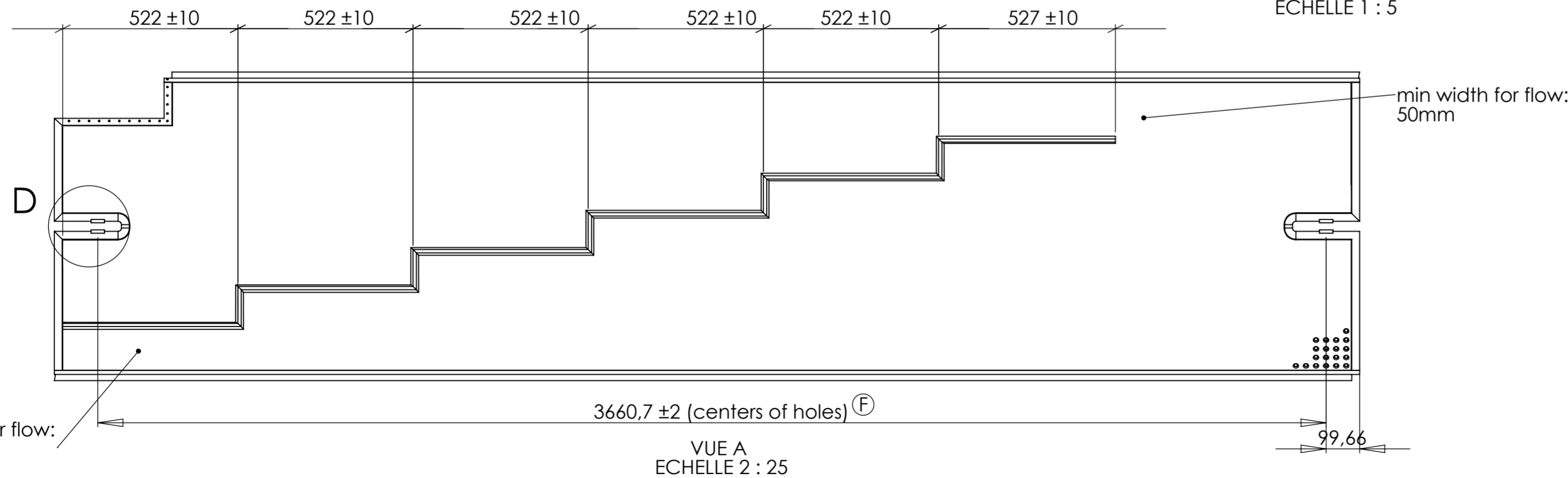

min width for flow: 50mm

min width for flow: 50mm

REVISIONS				
ZONE	REV.	DESCRIPTION	DATE	APPROUVE
	D	changed edges design	04/07/2012	
	E	oblong hole 5=>7	29/11/2012	
	F	changed position of holes	14/03/2013	

<b>SIGMAPHI</b> <i>zi du prat</i> Rue des frères Mongollier F-56000 Vannes			Name	M. Delbecq	Date	16/04/2013
Tel(33) 02.97.01.08.80 Fax (33)02.97.01.08.81 EMAIL Contact@sigmaphi.fr			Drawing			
			Checked			
			Approved			
			MATERIAL:	304L (X2CrNi18-9)		
			Trait.:			
			Roughness:			
			Toi Gen	+/-3		
			Supplier:			
			Weight:	121.00 Kg		
			File name:317111-JLA-702-003			
DWG NO. <b>317111-JLA-702-003</b>					Rev:	<b>F</b>
This drawing may not be used without special licence or authorisation express (Law of the 11 march 1957)			A2		SCALE:1:25	SHEET 1 OF 1