

A and B have to be considered as surfaces from ends to 20mm

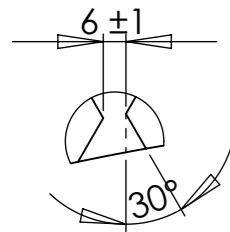

DÉTAIL K
ECHELLE 1 : 2

2 x groove for wire insertion
(with welding chamfers for filling after assembling)

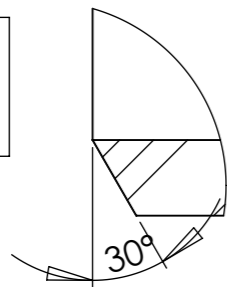

DÉTAIL A
ECHELLE 1 : 2

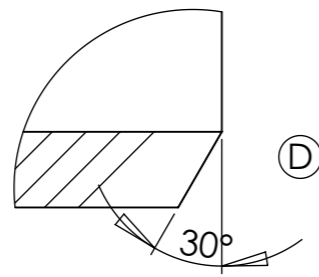

DÉTAIL B
ECHELLE 1 : 2



(or other ASME welding profile)
DÉTAIL J
ECHELLE 1 : 2
N° 703-002-S2

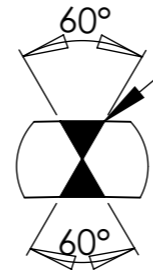

(or other ASME welding profile)
DÉTAIL C
ECHELLE 1 : 2
N° 703-002-S1

REVISIONS				
ZONE	REV.	DESCRIPTION	DATE	APPROUVE
	A1	CHANGES FOR INTERMEDIARY DESIGN REVIEW	20/10/2011	
	C	changed thickness and welding chamfers	03/05/2012	
	D	CHANGED WELDING PREPARATION	04/06/2012	
	E	changed the thickness (15 become 8mm)	23/10/2012	
	F	changed the thickness (8mm become 20mm)	27/03/2013	

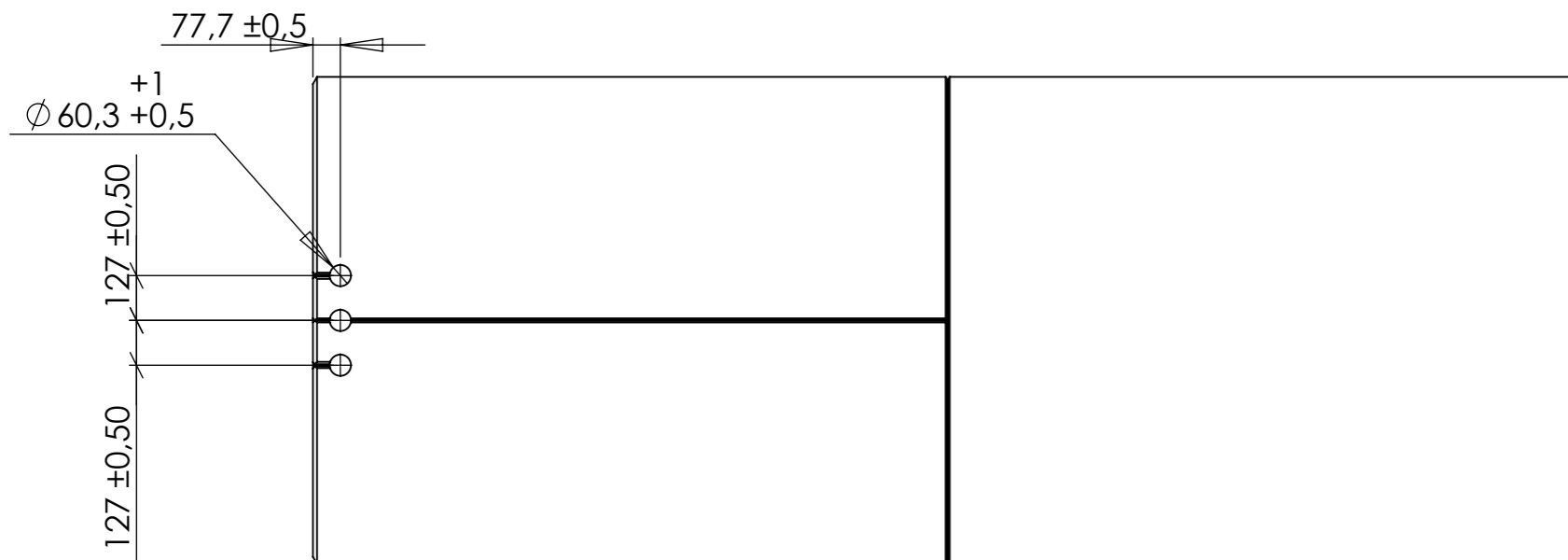
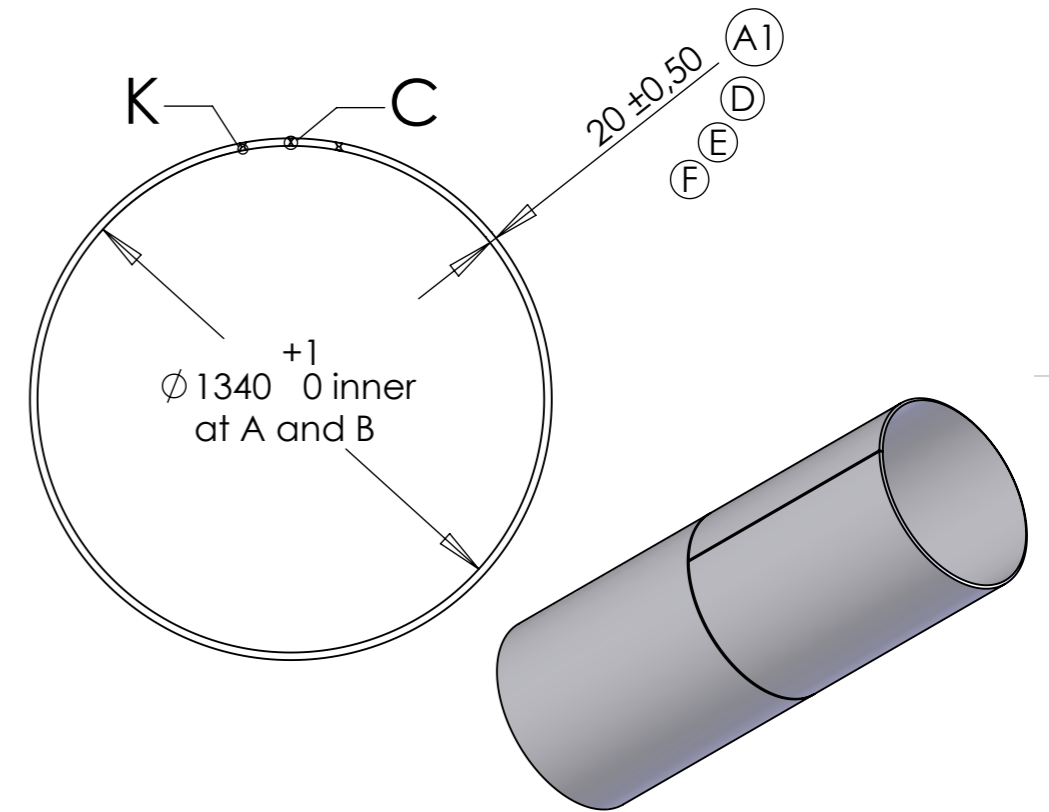
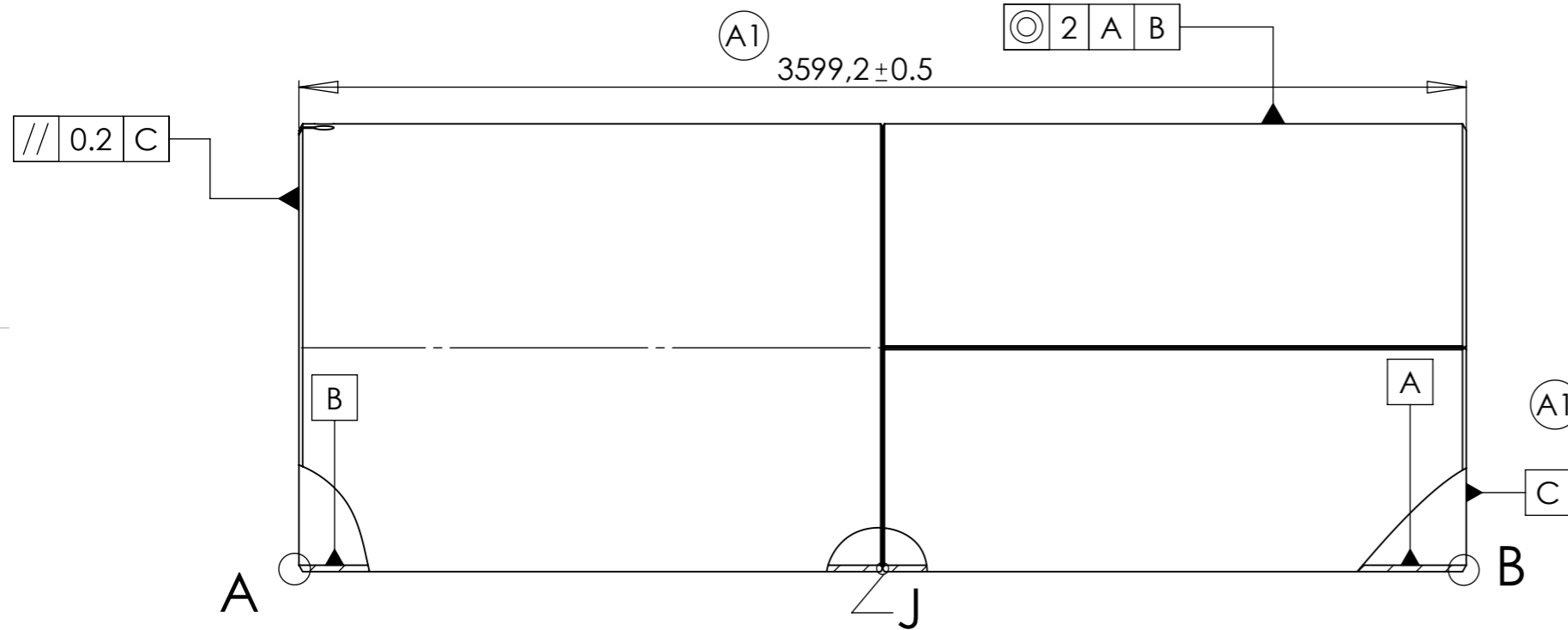

 ZI du prat Rue des frères Mongolfier F-56000 Vannes Tel(33) 02.97.01.08.80 Fax (33)02.97.01.08.81 EMAIL Contact@sigmaphi.fr	Name	M. Delbecq	Date	16/04/2013
	Drawing			
	Checked			
	Approved			
	MATERIAL:	304L (X2CrNi18-9)		
	Trait.:			
	Roughness :			
	Tol Gen	±2		
	Supplier:			
	Weight:	2413.17 Kg		
		0.00		
	File name:	317111-JLA-703-002		
DWG NO.	317111-JLA-703-002			Rev:
				F
This drawing may not be used without special licence or authorisation express (Law of the 11 march 1957)				A3 SCALE:1:50 SHEET 1 OF 1